

# BUILDING 2020

## FLOORPLAN

Up to 10,109 sq ft of fully-fitted laboratory, write-up and office space. Available as four individual units of 1,990 sq ft or combined to suit requirements.

**Available Space:** Ground Floor  
**EAST: UP TO 10,109 sq ft**

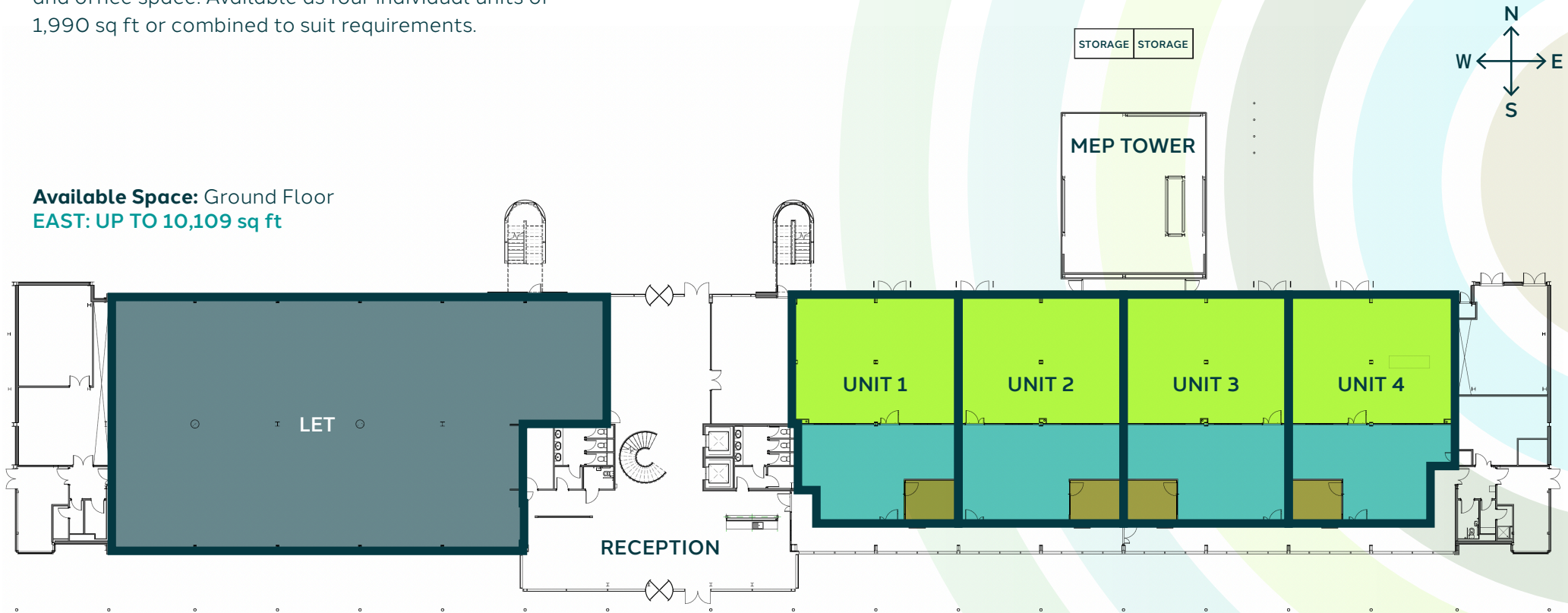

- Laboratory
- Write-up Space
- Meeting Room

TERMS: The property is available to let on effectively full repairing and insuring lease terms direct with the landlord. Please contact the letting agents for further details.

EPC: The Energy Performance Assessment rating: Building 2020 D-84.

# BUILDING 2020

## PROPOSED LABORATORY FIT OUT PLAN

